

AC=27°31'27"
 E=0,90m
 TC=7,43m
 R=30,37m

CABECEIRAS NOVAS

Comprimento= 11,98m
 Largura= 4,03m
 Altura= 3,72m ct 837,56
 Lâmina d'agua= ct 833,84
 Fundo D'agua= ct 833,62
 Máxima Cheia= 839,06

PALMEIRA
 ESC.: 1/250

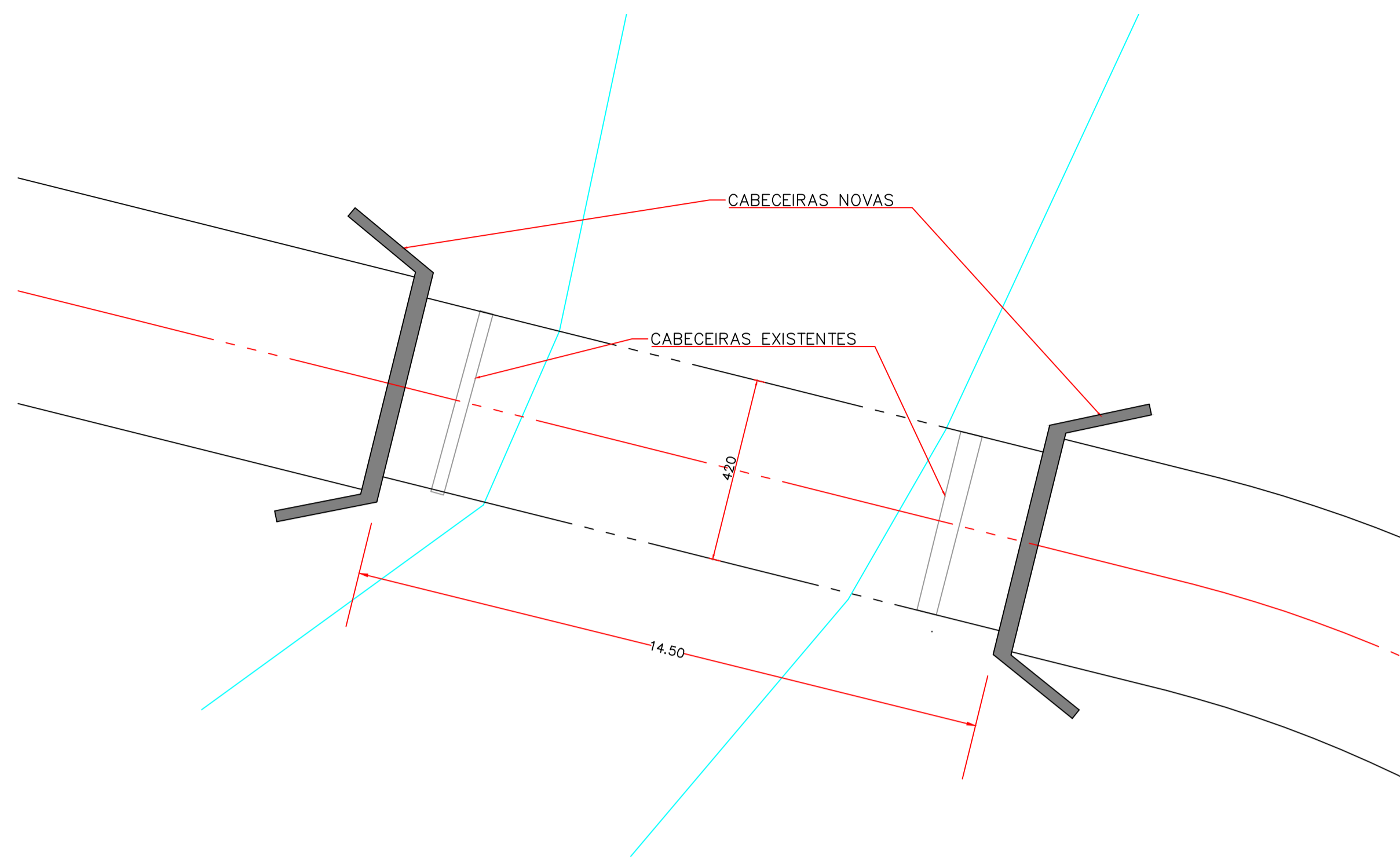

LOCAÇÃO CABECEIRAS
 ESC.: 1/100

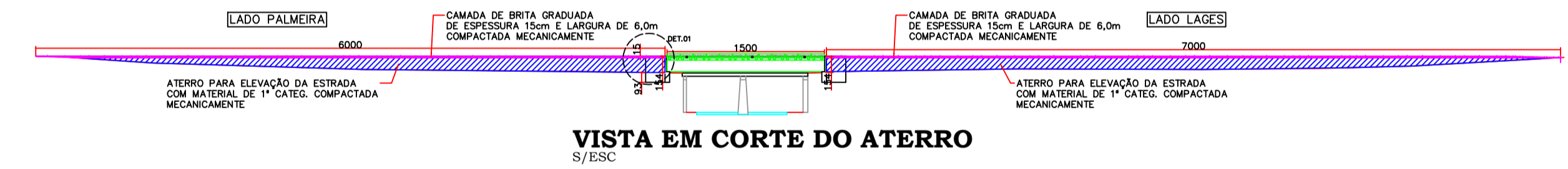

VISTA EM CORTE DO ATERRO
 S/ESC

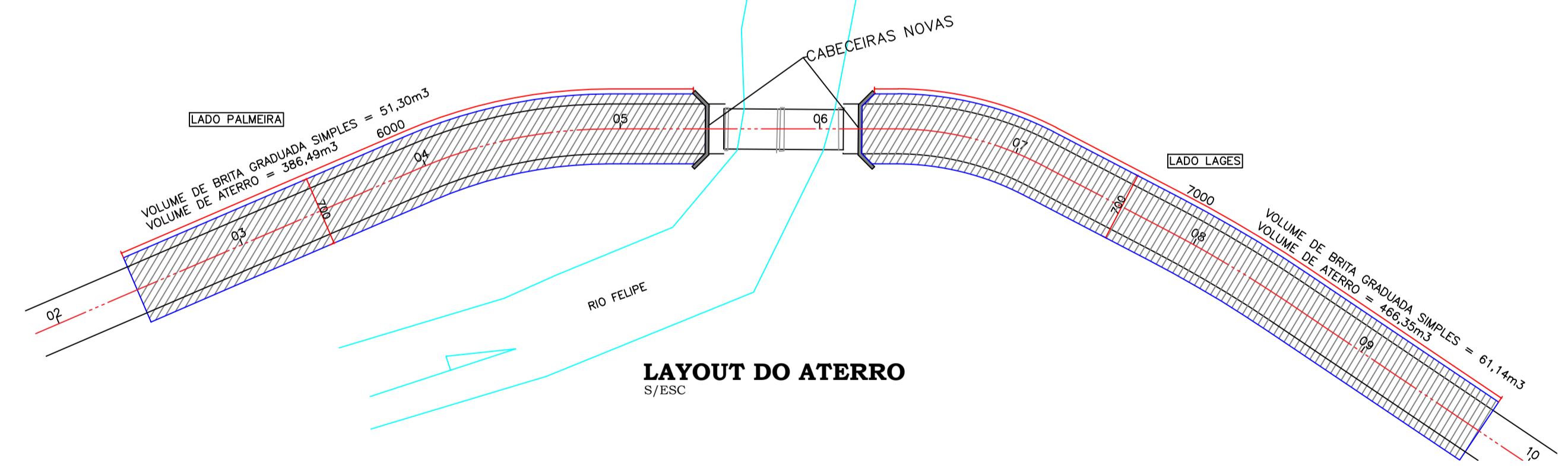

LAYOUT DO ATERRO
 S/ESC

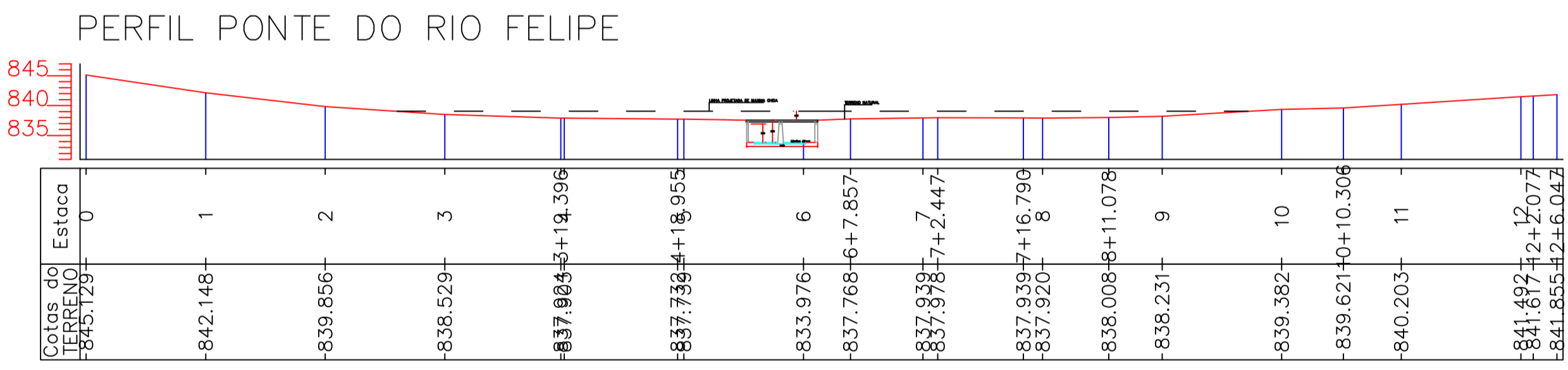

PERFIL LONGITUDINAL
 ESC.: 1/500

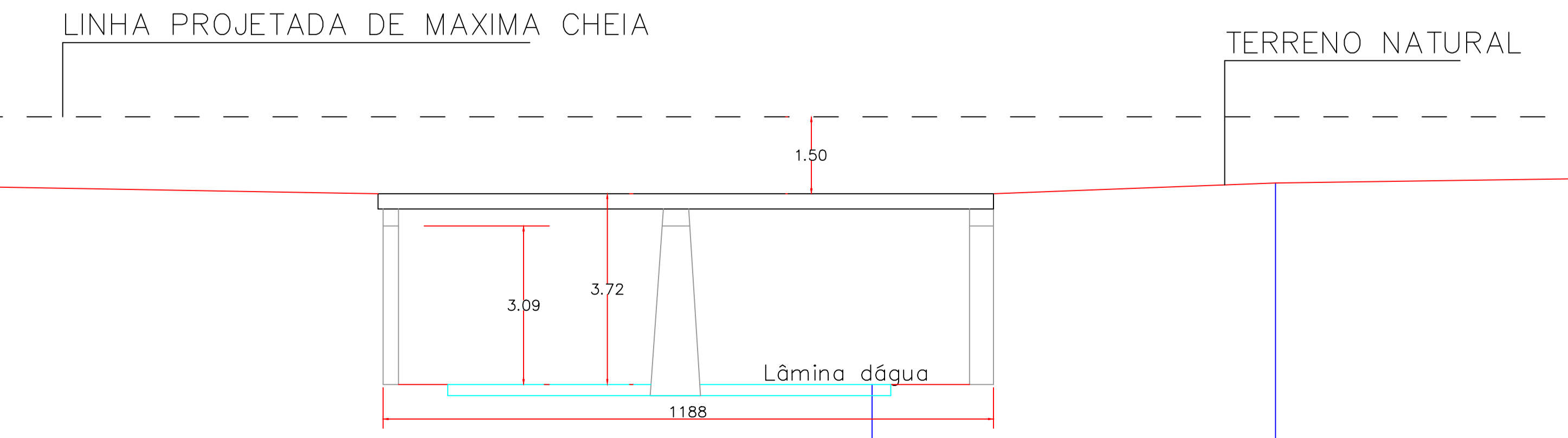

PERFIL LONGITUDINAL
 ESC.: 1/500

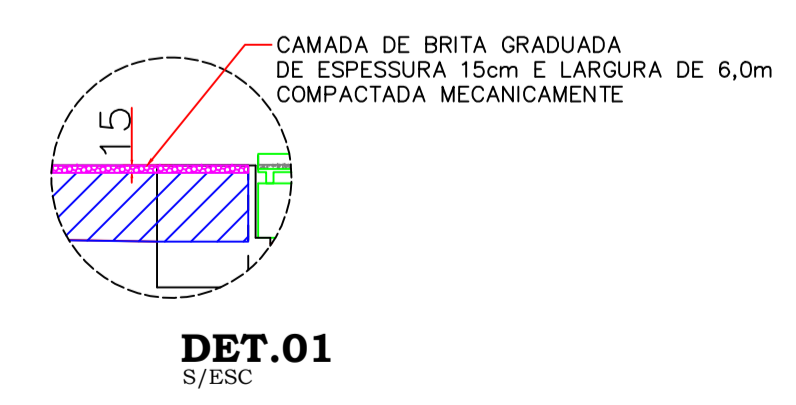

DET.01
 S/ESC

AMURES  ASSOCIAÇÃO DE MUNICÍPIOS DA REGIÃO SERRANA		01/03
PREFEITURA MUNICIPAL DE PALMEIRA		
ASSESSORIA TÉCNICA		OBRA: PONTE SOBRE O RIO FELIPE Divisa de Palmeira e Lages
PROJETO: James André Clauberg Eng. Civil - CREA 45.160-6		Levantamento Topográfico
PREFEITO: Fernanda de Souza Cordova		
DESENHO:	TOPOGRAFIA:	DATA: Indicada SET/2021